

AREA STATEMENT AND POPULATION CHART - (ALREADY SANCTION) PHASE 1

BUILDING DESCRIPTION		AREA CALCULATION		POPULATION STATEMENT		TOTAL
BUILDING TYPE	DESCRIPTION	GROUND COVERAGE (sqm)	FAR (sqm)	NO. OF APARTMENTS	POPULATION BREAK UP	(Main + Serviced)
TOWER EAST	G-27			230	Main Population (83777 / 1195)	
TOWER WEST	G-24			194	10% of the main Dwelling Units = 433 x 10 / 100 = 44 Units	
CLUB	G-11	5,581,722	62973,678		Home Service Population = 44 x 2 = 88 Person / Room	
SHOPPING	G				EWS Population = 77 x 2 = 154 Person	
EMIS	S-14	528,015	1748,311	77		242
GRAND TOTAL		6,592,247	64718,887	510	2169	2807

AREA STATEMENT AND POPULATION CHART - (REVISED SANCTION) PHASE 2

BUILDING DESCRIPTION		AREA CALCULATION		POPULATION STATEMENT		TOTAL
BUILDING TYPE	DESCRIPTION	GROUND COVERAGE (sqm)	FAR (sqm)	NO. OF APARTMENTS	POPULATION BREAK UP	(Main + Serviced)
TOWER 1A	G-34			320	Main Population (83777 / 1195)	
CLUB	G	1,982,830	28838,847		10% of the main Dwelling Units = 320 x 10 / 100 = 32 Units	
SHOPPING	G				Home Service Population = 32 x 2 = 64 Person / Room	
EMIS	S-13	244,3	1682,835	58		180
GRAND TOTAL		2,029,243	27488,482	378	1490	1768

- LEGEND
- Storm Water Line
 - Irrigation Water Supply
 - Municipal Water Line
 - Fire Tender Path

- LEGEND
- Demarcation line
 - Setback line
 - Basement profile
 - Organized greens line
 - 6.0m wide fire tender path
 - 1.5M wide green
 - Organized greens
 - Organized hard greens

NOTES:

1. All building shall have 100% power back up.
2. All Electrical installations shall be as per prevalent NBC provisions.
3. Fire fighting/safety provisions will be as per prevalent NBC provisions.
4. Roof slab of upper basement is designed to take fire tender load.

AREA STATEMENT AND POPULATION CHART - (REVISED SANCTION) PHASE 2

BUILDING DESCRIPTION		AREA CALCULATION		POPULATION STATEMENT		TOTAL
BUILDING TYPE	DESCRIPTION	GROUND COVERAGE (sqm)	FAR (sqm)	NO. OF APARTMENTS	POPULATION BREAK UP	(Main + Serviced)
TOWER 1A	G-34			320	Main Population (83777 / 1195)	
CLUB	G	1,982,830	28838,847		10% of the main Dwelling Units = 320 x 10 / 100 = 32 Units	
SHOPPING	G				Home Service Population = 32 x 2 = 64 Person / Room	
EMIS	S-13	244,3	1682,835	58		180
GRAND TOTAL		2,029,243	27488,482	378	1490	1768

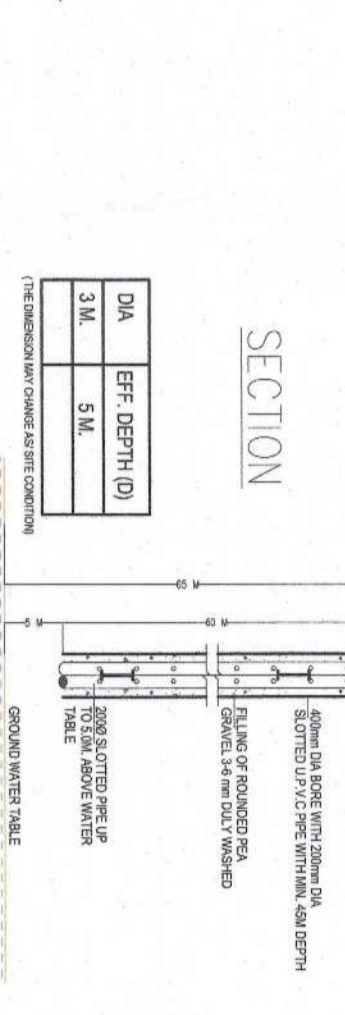

KEY PLAN:

Area	Area	Area	Area	Area	Area	Area	Area	Area	Area
Area 1	Area 2	Area 3	Area 4	Area 5	Area 6	Area 7	Area 8	Area 9	Area 10
27,481.55	26,500.00	1,133,226.00	27,481.55	1,133,226.00	27,481.55	1,133,226.00	27,481.55	1,133,226.00	27,481.55
1.00	1.00	1.00	1.00	1.00	1.00	1.00	1.00	1.00	1.00
27,481.55	26,500.00	1,133,226.00	27,481.55	1,133,226.00	27,481.55	1,133,226.00	27,481.55	1,133,226.00	27,481.55
1.00	1.00	1.00	1.00	1.00	1.00	1.00	1.00	1.00	1.00
27,481.55	26,500.00	1,133,226.00	27,481.55	1,133,226.00	27,481.55	1,133,226.00	27,481.55	1,133,226.00	27,481.55
1.00	1.00	1.00	1.00	1.00	1.00	1.00	1.00	1.00	1.00
27,481.55	26,500.00	1,133,226.00	27,481.55	1,133,226.00	27,481.55	1,133,226.00	27,481.55	1,133,226.00	27,481.55
1.00	1.00	1.00	1.00	1.00	1.00	1.00	1.00	1.00	1.00
27,481.55	26,500.00	1,133,226.00	27,481.55	1,133,226.00	27,481.55	1,133,226.00	27,481.55	1,133,226.00	27,481.55
1.00	1.00	1.00	1.00	1.00	1.00	1.00	1.00	1.00	1.00

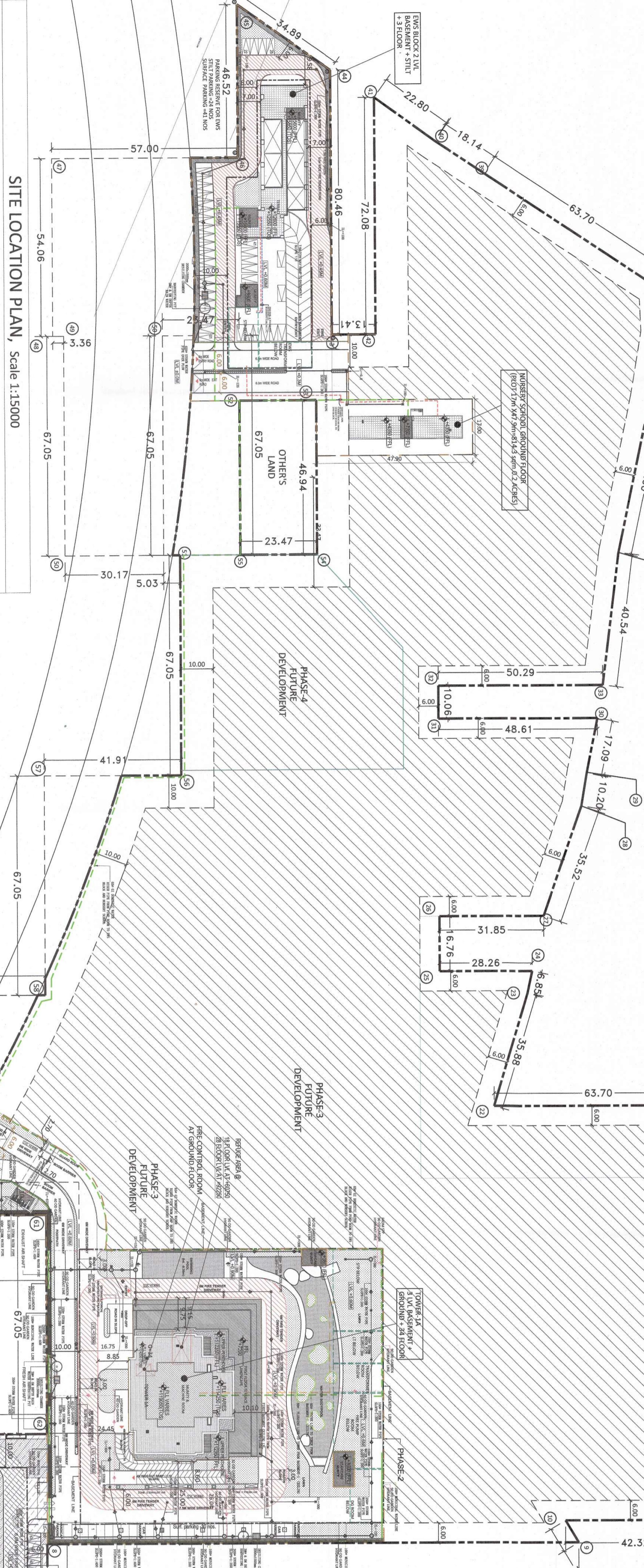

SITE LOCATION PLAN, Scale 1:15000

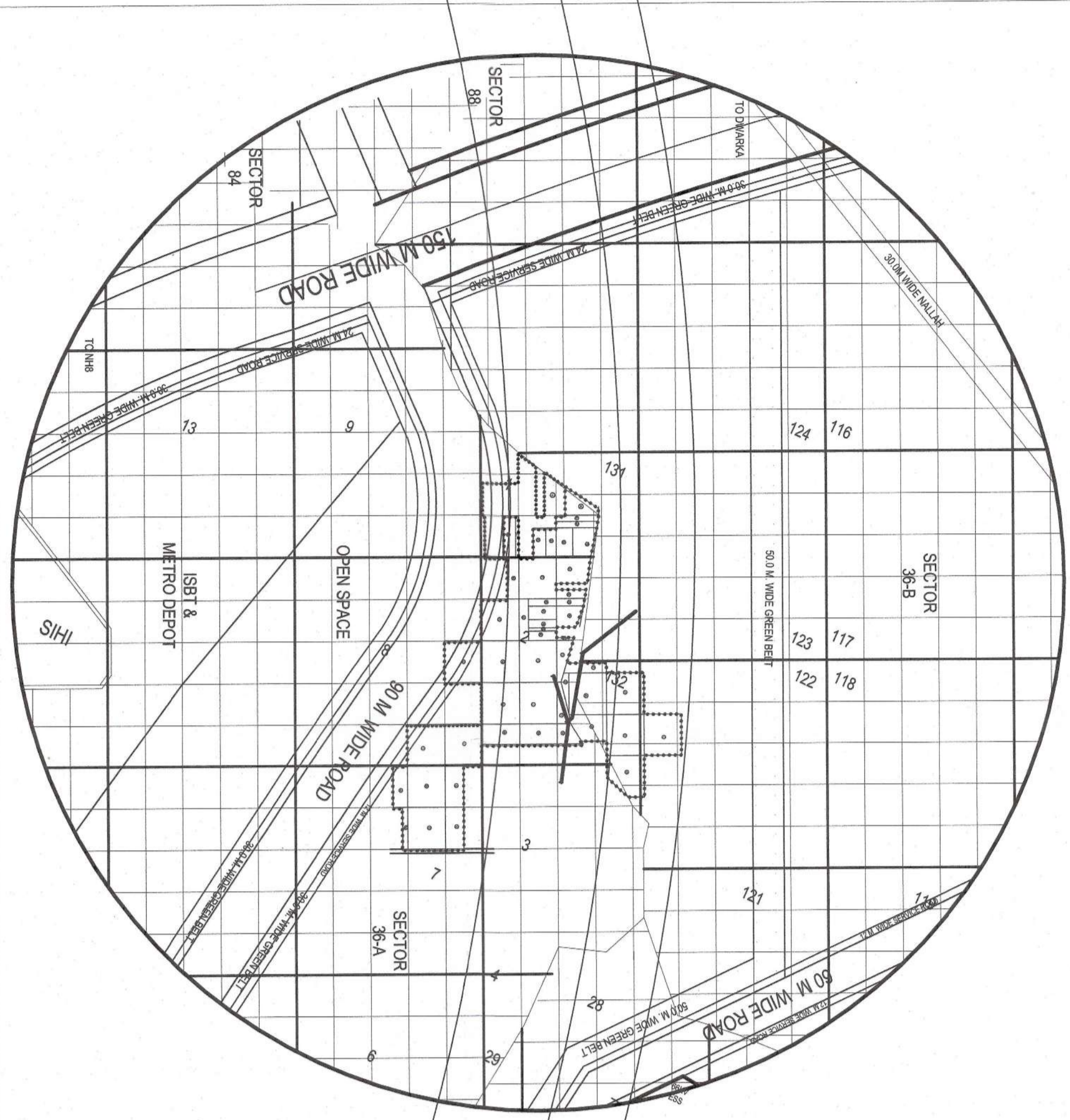

AUTHORITY STAMP:

TO THE FIELD OFFICE
 PROJECT NO. 19-12-2022
 DATE: 19-12-2022

PROJECT ARCHITECT:
 Rajeev Agarwal architects
 1-1083, Chhatrapati Shivaji Maharaj
 New Delhi - 110019
 www.rajeevagarwal.com

PROJECT LANDSCAPE CONSULTANTS:
 Greenbox Designs
 P-1/23, DLF City Phase 2
 Gurgaon
 Haryana, India

PROJECT TITLE:
 REVISED Building Plans Of Group Housing Colony
 Area Measuring 27,48,125 Acres
 (25-10 Acres Under Licence No. 39 of 2013 Dated 04.06.2013
 and 2,38,725 Acres Under
 Licence No. 85 of 2014 Dated 08.08.2014) in Sector-36-A,
 Gurgaon Mansarovar Urban Complex Being Developed By
 BUEJAN'S REALTECH PVT. LTD.
 (KRISJINI CORPORATION PVT. LTD.)

OWNER SIGNATURE / STAMP:
 RAJEEV KUMAR AGARWAL
 ARCHITECT
 CHARTERED

STRUCTURE CONSULTANT SIGNATURE / STAMP:
 NNC DESIGN INTERNATIONAL
 CONSULTING STRUCTURAL ENGINEERS
 7/20-21, 2nd FLOOR, JAYNARAYAN NAGAR, NEW DELHI
 PHONE NO. 491-11-0888/22/491-11-0888/22
 www.nncdesign.com

DRAWING TITLE:
 SITE PLAN

SCALE: 1:500
 DATE: 19 - MAY - 2022
 DRAWING NO. SP-1

REVISIONS:

NO.	DESCRIPTION
1	ISSUANCE
2	FOR COMMENTS
3	FOR COMMENTS
4	FOR COMMENTS
5	FOR COMMENTS
6	FOR COMMENTS
7	FOR COMMENTS
8	FOR COMMENTS
9	FOR COMMENTS
10	FOR COMMENTS